



PAVEMENT LEGEND	
	<b>HEAVY DUTY PAVEMENT</b> 2 1/4" BITUMINOUS SURFACE COURSE, HOT-MIX ASPHALT, MIX D, N50 2 1/4" BITUMINOUS BINDER COURSE, HOT-MIX ASPHALT, IL-19, N50 12" AGGREGATE BASE COURSE, TYPE B
	<b>SIDEWALK</b> 6" PCC SIDEWALK WITH COMPACTED SUBBASE (REFER TO DETAILS)
	<b>MILL &amp; OVERLAY (2")</b>



EXISTING  
BUILDING

PROPOSED CONCRETE  
SIDEWALK TO REPLACE  
EX. ASPHALT

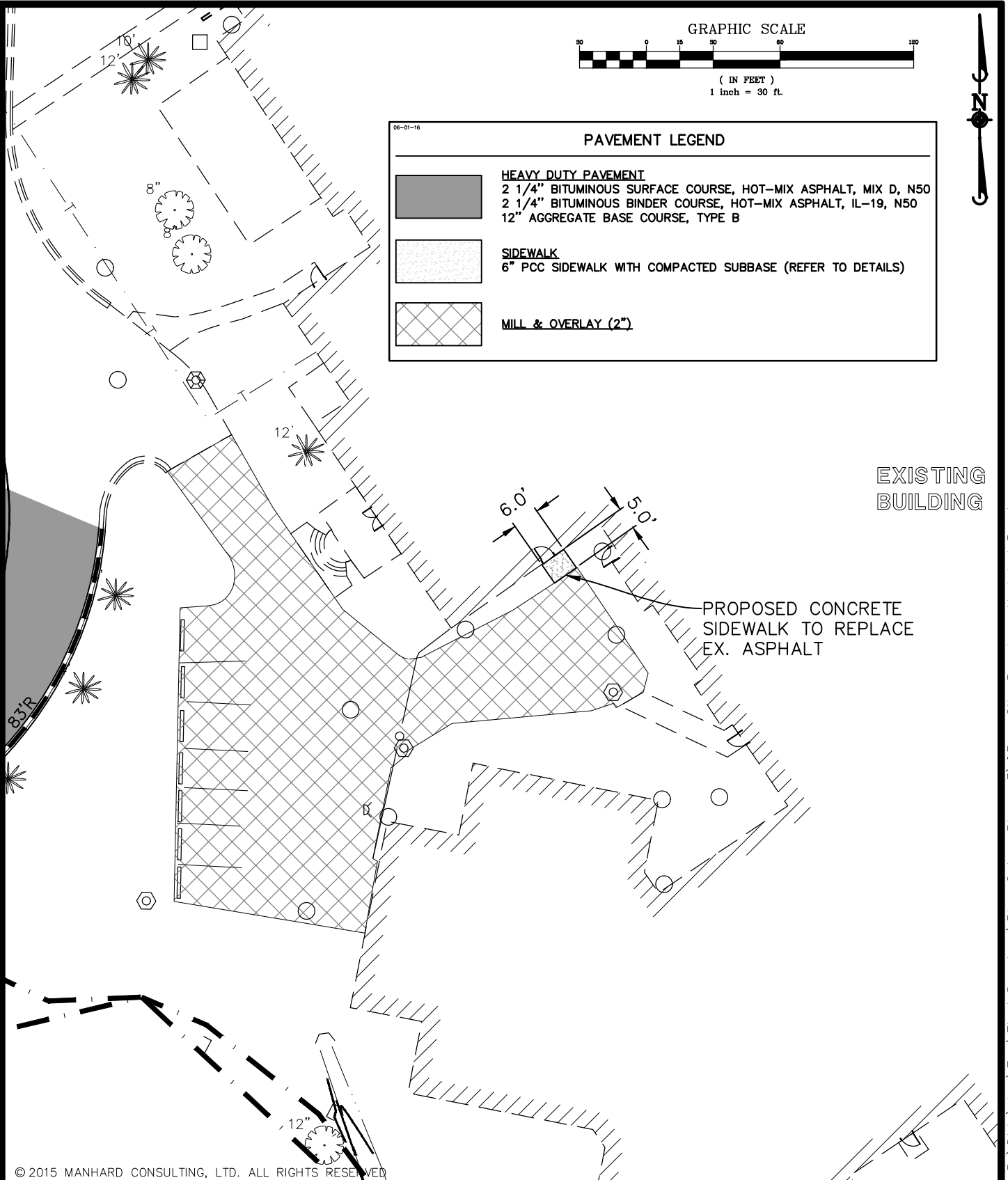
© 2015 MANHARD CONSULTING, LTD. ALL RIGHTS RESERVED



700 Springer Drive, Lombard, IL 60148 ph: 630.691.8500 fx: 630.691.8585 manhard.com  
Civil Engineers • Surveyors • Water Resource Engineers • Water & Wastewater Engineers  
Construction Managers • Environmental Scientists • Landscape Architects • Planners

DEPKE JUSTICE CENTER - PAVING IMPROVEMENTS

LAKE COUNTY, ILLINOIS

ENTRANCE SIDEWALK EXHIBIT

PROJ. MGR.: SMS  
DRAWN BY: HCM  
DATE: 06-09-17  
SCALE: 1"=30'

SHEET

**EXHIBIT 1**  
DLRLC

Dwg Name: P:\Dlrlc\dwg\Eng\Final Drawings\Plan Set - Phase 3\03 - Site Pav.dwg Updated By: hmeyer 08:37